

**SOUTH DAKOTA STATE HISTORIC PRESERVATION OFFICE
HISTORIC SITES SURVEY STRUCTURE FORM**



SITE INFORMATION

*SURVEY DATE: July 9, 2012 *ADDRESS: 31751 455th Ave.
*SURVEYOR: Jim Stone *COUNTY: Clay
*CITY: Meckling

LOCATION DESCRIPTION: From intersection of South Dakota Highway 50 bi-pass and South Dakota Highway 19, West about 1 mile to South Dakota Highway 19 South, turn left about 300' to Timber Road, turn right (West) about 6 miles to 455th Ave., turn left (South) about 1/2 mile, turn right (West), lane is about 1/4 mile long.

LEGAL DESCRIPTION: NW 1/4, SE 1/4 & 33' N side NE 1/4, SE 1/4, 16 - 92 - 53 Norway Twp.

*QUARTER 1: SE 1/4
*QUARTER 2: _____
*TOWNSHIP: Norway
*RANGE: 53
*SECTION: 16
ACRES: 41.24

OWNER NAME: Rita (Jorgensen) Weeldreyer
OWNER ADDRESS: 31751 455th Ave.
OWNER CITY: Meckling
OWNER STATE: South Dakota
OWNER ZIP: 57069
QUAD NAME: _____

OWNER CODE 1: P
OWNER CODE 2: F S L P
OWNER CODE 3: F S L P

HISTORIC SIGNIFICANCE

*DOE: _____
*DOE DATE: _____
REASON INELIGIBLE: _____

REGISTER NAME: _____
MULTIPLE PROPERTY NAME: _____

NOMINATION STATUS: _____
DATE LISTED: _____
REFERENCE NUMBER: _____
HISTORIC DISTRICT RATING: C or NC
PERIOD: _____

CATEGORY: _____
SIGNIFICANCE LEVEL 1: N S L
SIGNIFICANCE LEVEL 2: N S L
CRITERIA 1: A B C D
CRITERIA 2: A B C D
CRITERIA 3: A B C D
CRITERIA 4: A B C D

SIGNIFICANCE NOTES: _____

**SOUTH DAKOTA STATE HISTORIC PRESERVATION OFFICE
HISTORIC SITES SURVEY STRUCTURE FORM**



STRUCTURE DETAILS

SHPO ID: _____
*PROPERTY NAME: _____
OTHER NAME: _____

CURRENT FUNCTION: <u>Livestock barn</u>	FOUNDATION: <u>Poured concrete</u>
CURRENT SUBFUNCTION: <u>Storage</u>	ROOF MATERIAL: <u>Steel over cedar shingles</u>
HISTORIC FUNCTION: <u>Livestock barn</u>	ROOF SHAPE: <u>Gambrel</u>
HISTORIC SUBFUNCTION: <u>Hay storage</u>	STRUCTURAL SYSTEM: <u>Balloon framing</u>
OCCUPIED: <u>Yes</u>	STYLE: <u>Gambrel roof barn</u>
ACCESSIBLE: <u>Yes with permission</u>	TYPE: <u>Livestock barn</u>
	WALLS: <u>2x6, 1x6 #106 drop siding</u>

STORIES: 2 SIGNIFICANT PERSON: Andrew Jorgensen
*DATE OF CONSTRUCTION: ? CULTURAL AFFILIATION: Norwegian

ALTERED/MOVED NOTES: Original site. Roof has been covered with steel roofing. Some of the stalls have been removed. Lean-to's have been added to the South, West and North sides much later than the original barn.

INTERIOR NOTES: Has two rows of 6x6 posts and 6x8 beams to support hayloft floor. Joists were 2x8. All of the 2x6's for studs, rafters and bracing, 2x8 floor joists, 6x6 posts and 6x6 beams were rough sawn cottonwood.

OTHER NOTES: Windows were 8"x10" four light. Has a metal cupola. A good example of a braced rafter system.

*PHYSICAL NOTES: Barn is in fair condition. Needs some maintance.

**SOUTH DAKOTA STATE HISTORIC PRESERVATION OFFICE
HISTORIC SITES SURVEY STRUCTURE FORM**

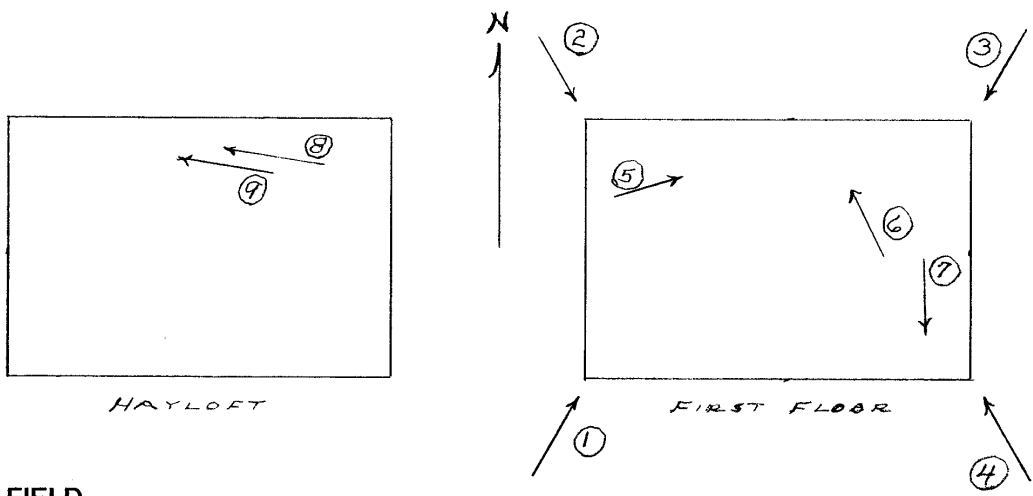
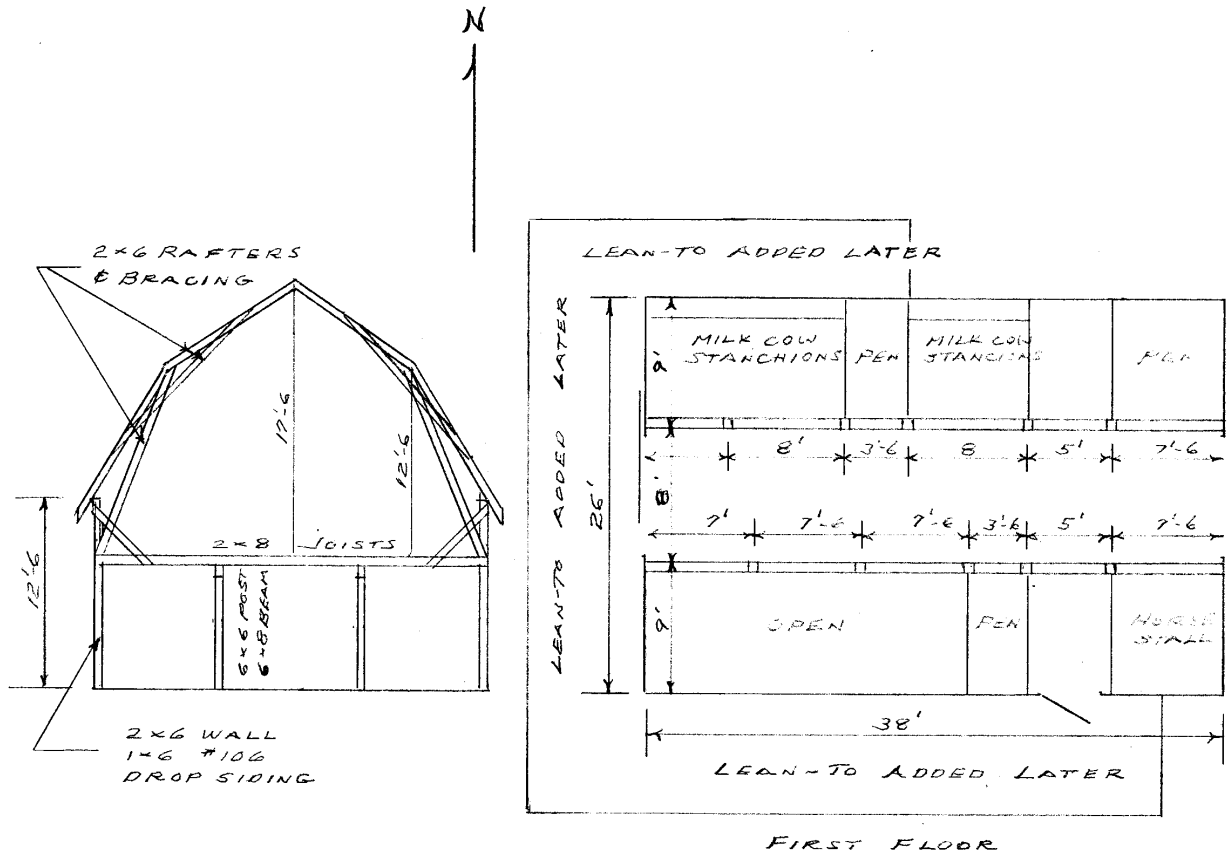

* = REQUIRED FIELD

**SOUTH DAKOTA STATE HISTORIC PRESERVATION OFFICE
HISTORIC SITES SURVEY STRUCTURE FORM**



PHOTOGRAPHER: Jim Stone
DATE OF PHOTO: July 9, 2012

ROLL NUMBER: _____
PHOTO NUMBER: 1
CAMERA DIRECTION: Looking NE, SW corner



PHOTOGRAPHER: Jim Stone
DATE OF PHOTO: July 9, 2012

ROLL NUMBER: _____
PHOTO NUMBER: 2
CAMERA DIRECTION: Looking SE, NW corner

**SOUTH DAKOTA STATE HISTORIC PRESERVATION OFFICE
HISTORIC SITES SURVEY STRUCTURE FORM**



PHOTOGRAPHER: Jim Stone
DATE OF PHOTO: July 9, 2012

ROLL NUMBER: _____
PHOTO NUMBER: 3
CAMERA DIRECTION: Looking SW, NE corner



PHOTOGRAPHER: Jim Stone
DATE OF PHOTO: July 9, 2012

ROLL NUMBER: _____
PHOTO NUMBER: 4
CAMERA DIRECTION: Looking NW, SE corner

**SOUTH DAKOTA STATE HISTORIC PRESERVATION OFFICE
HISTORIC SITES SURVEY STRUCTURE FORM**



PHOTOGRAPHER: Jim Stone
DATE OF PHOTO: July 9, 2012

ROLL NUMBER: 5
PHOTO NUMBER: 5

CAMERA DIRECTION: First floor, looking NE,
milk cow stall



PHOTOGRAPHER: Jim Stone
DATE OF PHOTO: July 9, 2012

ROLL NUMBER: 6
PHOTO NUMBER: 6

CAMERA DIRECTION: First floor, looking North,
three milk cow
stanchions

**SOUTH DAKOTA STATE HISTORIC PRESERVATION OFFICE
HISTORIC SITES SURVEY STRUCTURE FORM**



PHOTOGRAPHER: Jim Stone
DATE OF PHOTO: July 9, 2012

ROLL NUMBER: _____
PHOTO NUMBER: 7

CAMERA DIRECTION: First floor, looking South, only horse stall left



PHOTOGRAPHER: Jim Stone
DATE OF PHOTO: July 9, 2012

ROLL NUMBER: _____
PHOTO NUMBER: 8

CAMERA DIRECTION: Hayloft, looking West, lower rafter & wall bracing

**SOUTH DAKOTA STATE HISTORIC PRESERVATION OFFICE
HISTORIC SITES SURVEY STRUCTURE FORM**



PHOTOGRAPHER: Jim Stone
DATE OF PHOTO: July 9, 2012

ROLL NUMBER: _____
PHOTO NUMBER: 9
CAMERA DIRECTION: Hayloft, looking West,
upper rafter bracing

**SOUTH DAKOTA STATE HISTORIC PRESERVATION OFFICE
HISTORIC SITES SURVEY STRUCTURE FORM**



T-92-N NORWAY DIRECTORY R-52-53-W

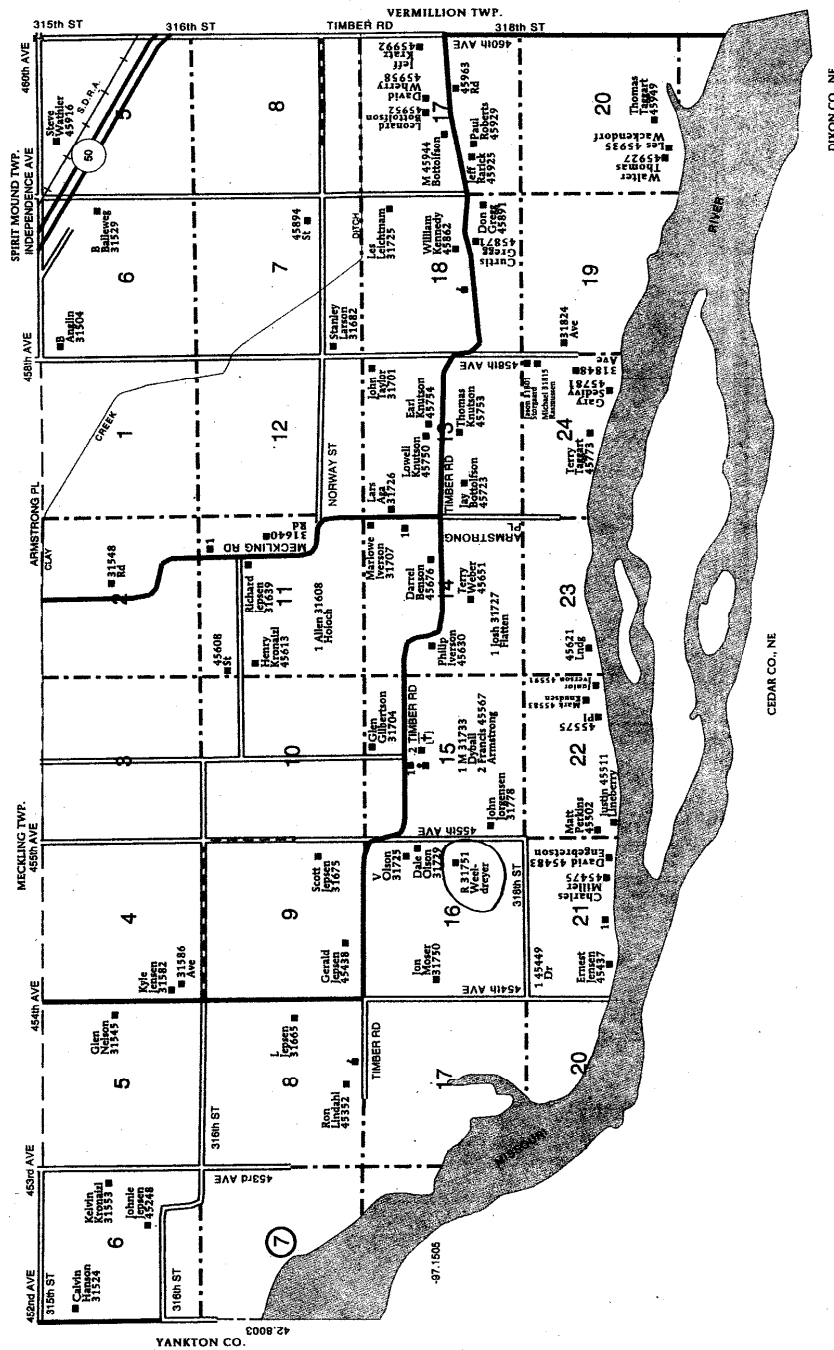

HISTORY

This Section 16 was a School Section and could not be homesteaded. And rents or sale of any part of the Section 16 went to a county fund for rural schools.

The 1894 Clay County Atlas lists A. Jorgenson as the owner

The 1901, 1912, 1924, 1937 and 1948 Clay County Atlas lists Andrew Jorgenson as the owner.

The 1956 Clay County Atlas lists Harry Jorgenson as the owner.