

**SOUTH DAKOTA STATE HISTORIC PRESERVATION OFFICE
HISTORIC SITES SURVEY STRUCTURE FORM**



SITE INFORMATION

*SURVEY DATE: November 27, 2012 *ADDRESS: 30624 464th Ave.
*SURVEYOR: Jim Stone *COUNTY: Clay
*CITY: Centerville

LOCATION DESCRIPTION: From the intersection of South Dakota Highway 50 bi-pass and University Ave., North 12 miles to 306th Street, turn left (West) 1 mile to 464th Ave., turn left (South) 1/4 mile, on the left (East) side. Long lane back to farm.

LEGAL DESCRIPTION: E 1/2 , NW 1/4, Exc W 121' of S 1,287' of Lot 1, NW 1/4 & Exc Lindstrom tract 1, 19 – 94 – 51 Garfield Twp.

*QUARTER 1: NW 1/4
*QUARTER 2: _____
*TOWNSHIP: Garfield
*RANGE: 51
*SECTION: 19
ACRES: 35.44

OWNER NAME: Donald D. Lindstrom
OWNER ADDRESS: 30467 464th Ave
OWNER CITY: Centerville
OWNER STATE: South Dakota
OWNER ZIP: 57014
QUAD NAME: _____

OWNER CODE 1: P
OWNER CODE 2: _____
OWNER CODE 3: _____

HISTORIC SIGNIFICANCE

*DOE: _____
*DOE DATE: _____
REASON INELIGIBLE: _____

REGISTER NAME: _____
MULTIPLE PROPERTY NAME: _____

NOMINATION STATUS: _____
DATE LISTED: _____
REFERENCE NUMBER: _____
HISTORIC DISTRICT RATING: C or NC
PERIOD: _____

CATEGORY: _____
SIGNIFICANCE LEVEL 1: N S L
SIGNIFICANCE LEVEL 2: N S L
CRITERIA 1: A B C D
CRITERIA 2: A B C D
CRITERIA 3: A B C D
CRITERIA 4: A B C D

SIGNIFICANCE NOTES: _____

STRUCTURE DETAILS

* = REQUIRED FIELD

**SOUTH DAKOTA STATE HISTORIC PRESERVATION OFFICE
HISTORIC SITES SURVEY STRUCTURE FORM**



SHPO ID: _____
 *PROPERTY NAME: _____
 OTHER NAME: _____

CURRENT FUNCTION:	<u>Calving and cattle</u>	FOUNDATION:	<u>Poured concrete foundation</u>
CURRENT SUBFUNCTION:	<u>Storage</u>	ROOF MATERIAL:	<u>Cedar shingles</u>
HISTORIC FUNCTION:	<u>Livestock barn</u>	ROOF SHAPE:	<u>Gothic round</u>
HISTORIC SUBFUNCTION:	<u>Hay storage</u>	STRUCTURAL SYSTEM:	<u>Balloon framing Wisconsin dairy barn</u>
		STYLE:	<u>barn</u>
OCCUPIED:	<u>Yes</u>	TYPE:	<u>Dairy barn 8" concrete block, 2x8 studs with 1x6 #106 drop siding on Hayloft gable ends</u>
		WALLS:	<u>ends</u>
ACCESSIBLE:	<u>Yes with permission</u>		
		SIGNIFICANT PERSON:	<u>A. M. Lindstrom & A. O. Lindstrom</u>
STORIES:	<u>2</u>	CULTURAL AFFILIATION:	<u>Swedish</u>
*DATE OF CONSTRUCTION:	<u>1954</u>		

ALTERED/MOVED NOTES: Original site. Milk room converted into dairy goat milking parlor.

INTERIOR NOTES: Has two rows of 4" steel pipe posts with (3) 2x10's for a beam. 2x6 floor joists for hayloft floor. Seven milk cow stanchions on the West side and seven milk cow stanchions are still in place with concrete feed trough and gutters. Calf pen is still in place in the SW corner.

OTHER NOTES: 8" concrete block walls 8' high, with 2x8 stud walls and 1x6 #106 drop siding on the gable ends in the hayloft. Rafters are site built from 1x8 cedar (3) plies thick and a 1 x full 4" cedar on the back side of each rafter. Windows are 9"x12" four light, steel windows that can be tilted for ventilation. 14' x 10' granary in the SE corner of hayloft. 12" round metal ductwork from hayloft floor up to metal cupola for ventilation.

*PHYSICAL NOTES: Barn is in good condition.

*UTM ZONE: _____ *RESTRICTED: Y or N
 *UTM EASTING: _____
 *UTM NORTHING: _____

* = REQUIRED FIELD

**SOUTH DAKOTA STATE HISTORIC PRESERVATION OFFICE
HISTORIC SITES SURVEY STRUCTURE FORM**

SKETCH MAP

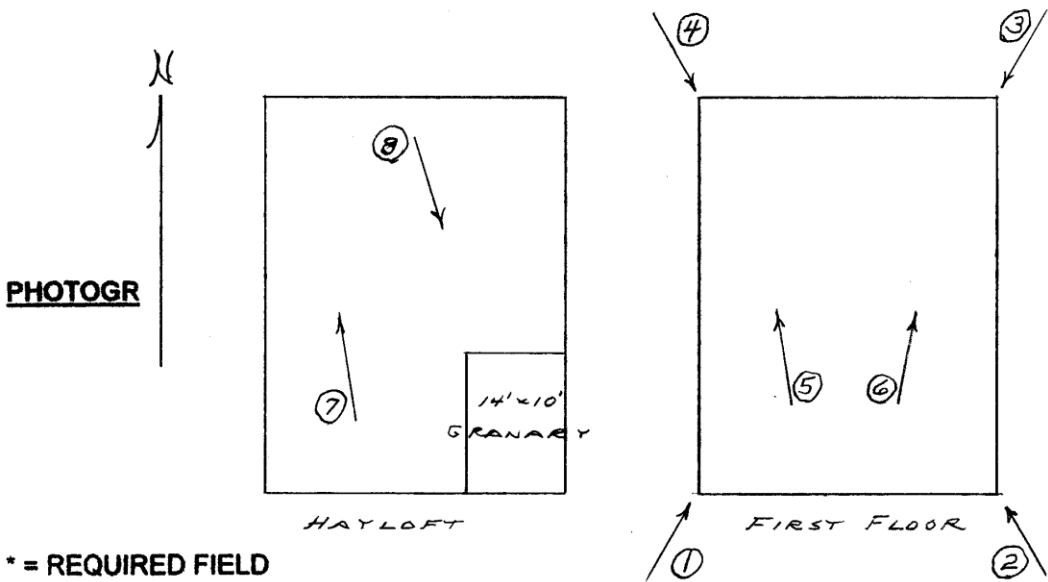
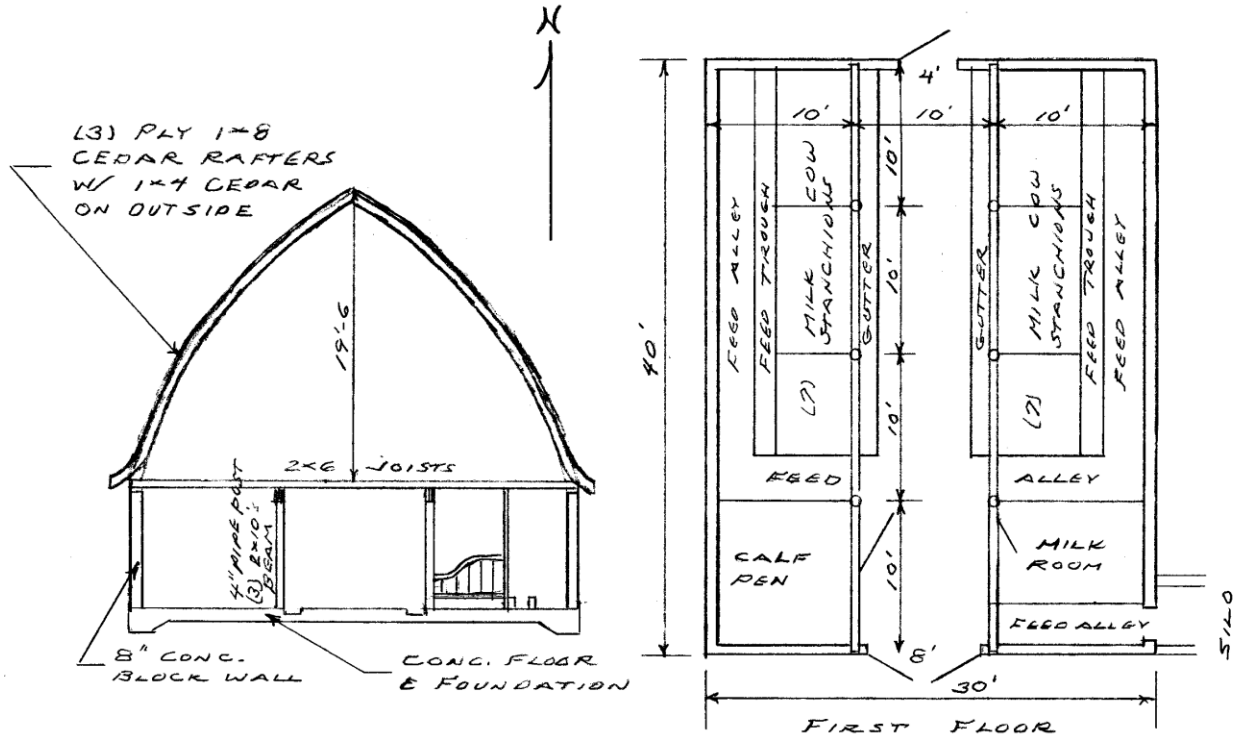

* = REQUIRED FIELD

* = REQUIRED FIELD

**SOUTH DAKOTA STATE HISTORIC PRESERVATION OFFICE
HISTORIC SITES SURVEY STRUCTURE FORM**



PHOTOGRAPHER: Jim Stone
DATE OF PHOTO: November 27, 2012

ROLL NUMBER: _____
PHOTO NUMBER: 1
CAMERA DIRECTION: Looking NE, SW corner



PHOTOGRAPHER: Jim Stone
DATE OF PHOTO: November 27, 2012

ROLL NUMBER: _____
PHOTO NUMBER: 2
CAMERA DIRECTION: Looking NW, SE corner

* = REQUIRED FIELD

**SOUTH DAKOTA STATE HISTORIC PRESERVATION OFFICE
HISTORIC SITES SURVEY STRUCTURE FORM**



PHOTOGRAPHER: Jim Stone
DATE OF PHOTO: November 27, 2012

ROLL NUMBER: _____
PHOTO NUMBER: 3
CAMERA DIRECTION: Looking SW, NE corner



PHOTOGRAPHER: Jim Stone
DATE OF PHOTO: November 27, 2012

ROLL NUMBER: _____
PHOTO NUMBER: 4
CAMERA DIRECTION: Looking SE, NW corner

* = REQUIRED FIELD

**SOUTH DAKOTA STATE HISTORIC PRESERVATION OFFICE
HISTORIC SITES SURVEY STRUCTURE FORM**



PHOTOGRAPHER: Jim Stone
DATE OF PHOTO: November 27, 2012

ROLL NUMBER: _____
PHOTO NUMBER: 5

CAMERA DIRECTION: First floor, looking NW, 7
milk cow stanchions on
West wall



PHOTOGRAPHER: Jim Stone
DATE OF PHOTO: November 27, 2012

ROLL NUMBER: _____
PHOTO NUMBER: 6

CAMERA DIRECTION: First floor, looking NE, 7
milk cow stanchions on
East wall

**SOUTH DAKOTA STATE HISTORIC PRESERVATION OFFICE
HISTORIC SITES SURVEY STRUCTURE FORM**



PHOTOGRAPHER: Jim Stone
DATE OF PHOTO: November 27, 2012

ROLL NUMBER: _____
PHOTO NUMBER: 7

**Hayloft, looking NW, site
built rafters, 3 ply 1x8
cedar w/ 1x4 on back
side**

CAMERA DIRECTION: _____



PHOTOGRAPHER: Jim Stone
DATE OF PHOTO: November 27, 2012

ROLL NUMBER: _____
PHOTO NUMBER: 8

**Hayloft, looking SE, 12"
metal ductwork up to
cupola to ventilate first
floor. Note 14' x 10'
granary in SE corner**

CAMERA DIRECTION: _____

SOUTH DAKOTA STATE HISTORIC PRESERVATION OFFICE
HISTORIC SITES SURVEY STRUCTURE FORM



T-94-N GARFIELD DIRECTORY R-51-W

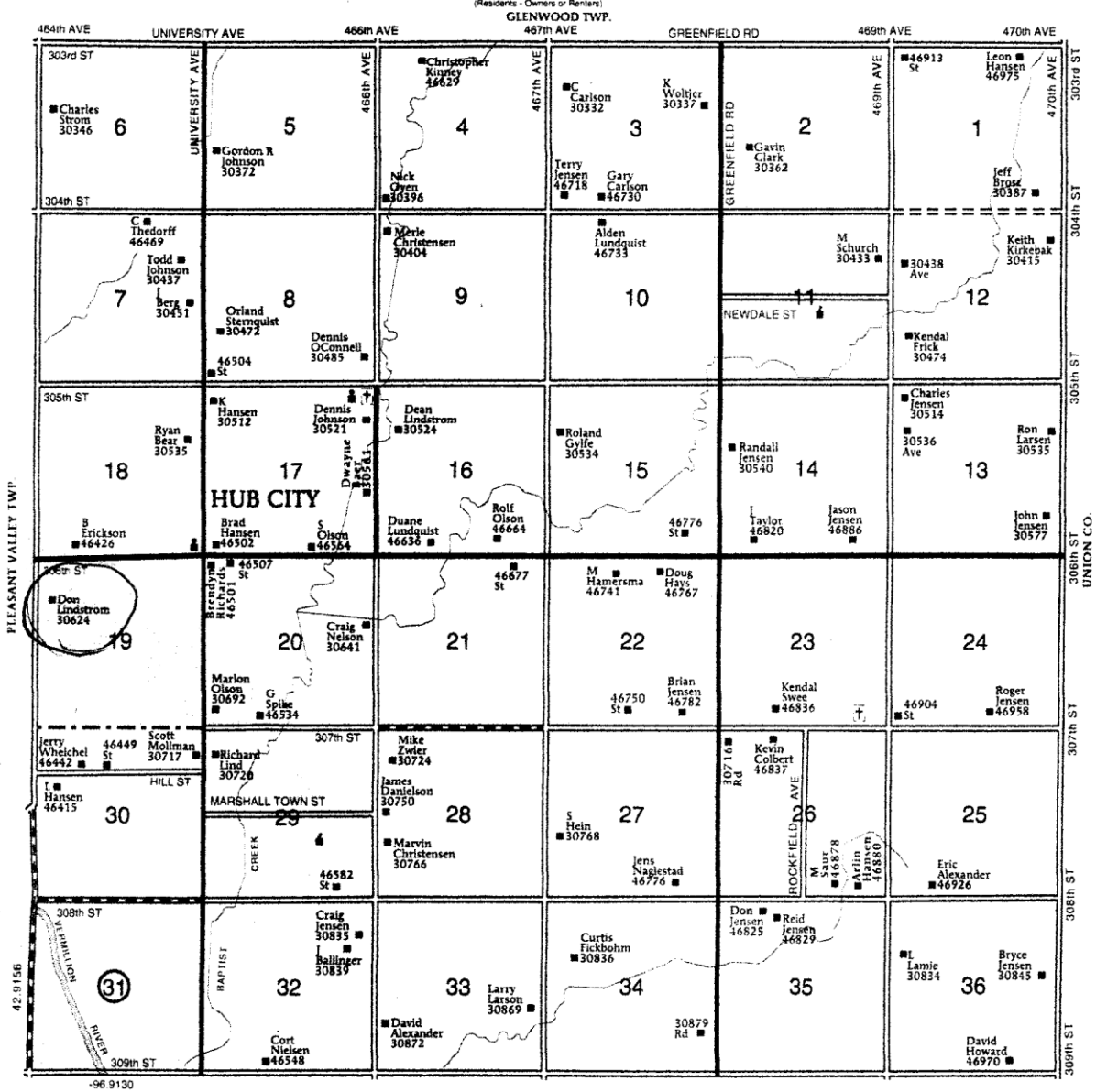

* = REQUIRED FIELD

HISTORY

This farm located in the E ½ of the NW ¼ in Section 19, Garfield Township, Clay County was homesteaded by Anders Matteson.

The 1894 Clay County Atlas lists Anderson Matteson Lindstrom as the owner.

The 1901 Clay County Atlas lists Anderson Matteson Lindstrom as the owner.

The 1912 Clay County Atlas lists Anders Matteson as the owner.

The 1924 Clay County Atlas lists A. M. Lindstrom as the owner.

The 1937, 1948 and 1956 Clay County Atlas lists A. O. Lindstrom as the owner.

The Following Information Was Furnished by
Donald Lindstrom, the present owner.

Builder was Joy Hansen in 1954.