

**SOUTH DAKOTA STATE HISTORIC PRESERVATION OFFICE
HISTORIC SITES SURVEY STRUCTURE FORM**



SITE INFORMATION

*SURVEY DATE: December 16, 2013 *ADDRESS: 31594 469th Ave.
*SURVEYOR: Jim Stone *COUNTY: Clay
*CITY: Burbank

LOCATION DESCRIPTION: From Vermillion, South Dakota Highway 50 East about 4 miles to 469th Ave., Turn left (North) about 1-1/2 miles, on the right (East) side. Just North of intersection of 316th Street and 469th Ave.

LEGAL DESCRIPTION: W 1/2, S 1/2, SW 1/4, 1 - 92 - 51 Fairview Twp.

*QUARTER 1: SW 1/4 OWNER NAME: Robert E. Solomon Living Trust
*QUARTER 2: _____ OWNER ADDRESS: 918 Madison
*TOWNSHIP: Fairview OWNER CITY: Vermillion
*RANGE: 51 OWNER STATE: South Dakota
*SECTION: 1 OWNER ZIP: 57069
ACRES: 40.31 QUAD NAME: _____
OWNER CODE 1: P
OWNER CODE 2:
OWNER CODE 3:

HISTORIC SIGNIFICANCE

*DOE: _____ REGISTER NAME: _____
*DOE DATE: _____ MULTIPLE PROPERTY NAME: _____
REASON INELIGIBLE: _____

NOMINATION STATUS: _____ CATEGORY: _____
DATE LISTED: _____ SIGNIFICANCE LEVEL 1: N S L
REFERENCE NUMBER: _____ SIGNIFICANCE LEVEL 2: N S L
HISTORIC DISTRICT RATING: C or NC CRITERIA 1: A B C D
PERIOD: _____ CRITERIA 2: A B C D
CRITERIA 3: A B C D
CRITERIA 4: A B C D

SIGNIFICANCE NOTES: _____

**SOUTH DAKOTA STATE HISTORIC PRESERVATION OFFICE
HISTORIC SITES SURVEY STRUCTURE FORM**



STRUCTURE DETAILS

SHPO ID: _____
*PROPERTY NAME: _____
OTHER NAME: _____

CURRENT FUNCTION: Vacant FOUNDATION: Poured concrete
CURRENT SUBFUNCTION: Straw storage ROOF MATERIAL: Cedar shingles
HISTORIC FUNCTION: Livestock barn ROOF SHAPE: Gambrel roof
HISTORIC SUBFUNCTION: Hay storage STRUCTURAL SYSTEM: Balloon framing
STYLE: Gambrel roof barn
OCCUPIED: No TYPE: Livestock barn
Yes with
ACCESSIBLE: permission WALLS: 2x6 studs, 1x10
#106 drop siding

STORIES: 2 SIGNIFICANT PERSON: A. A. Solomon
*DATE OF CONSTRUCTION: 1917 or 1918 CULTURAL AFFILIATION: _____

ALTERED/MOVED NOTES: Original site. Barn has been remodeled inside for raising younger weaned swine. New sloped concrete floor with slotted floor in the lower levels. Walls and ceiling insulated and lined. Posts and beams appear to have been moved. Posts are now steel pipe supporting the steel pens. Extensive ventilation system installed. Steel roofing applied on the lower 8' of exterior walls.

INTERIOR NOTES: Any evidence of horse stalls or milk cow stanchions has been removed. Interior completely remodeled.

OTHER NOTES: 2x6 stud walls with 1x10 shiplap and 1x6 #106 drop siding. False eaves with soffit added at ceiling height, with hinged soffit panels for ventilation on East and West walls.. Windows are 9"x 12" four light. Rafters are 2x6's with 2x6 bracing at the hip, 2' O. C. 2x6 bracing from center of lower rafter down to floor and exterior wall, 4' O. C. Metal cupola still on the roof.

***PHYSICAL NOTES:** Barn is in fair condition. ***RESTRICTED:** Y or N
*UTM EASTING: _____
*UTM NORTHING: _____

**SOUTH DAKOTA STATE HISTORIC PRESERVATION OFFICE
HISTORIC SITES SURVEY STRUCTURE FORM**

SKETCH MAP

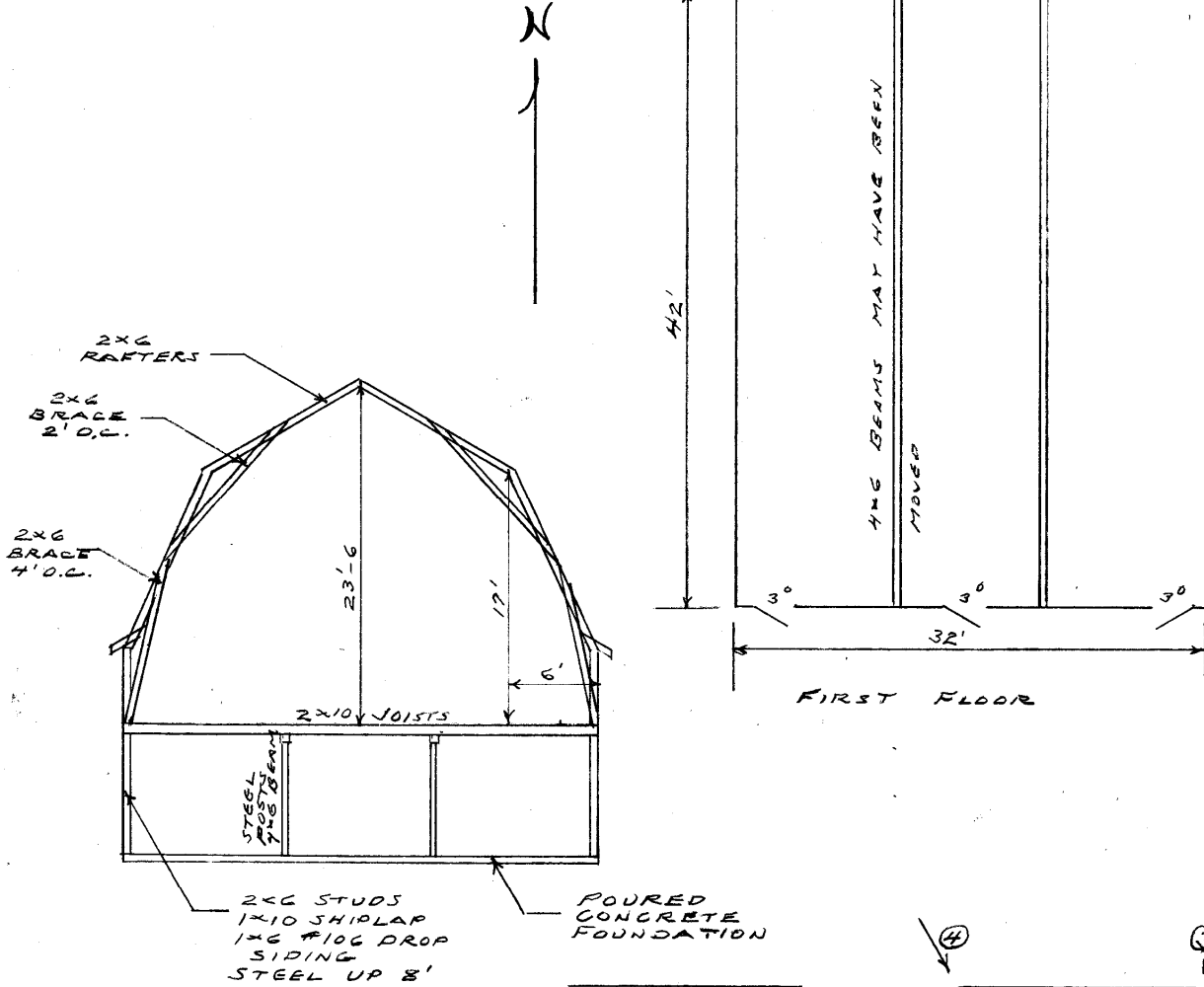

PHOTOGR

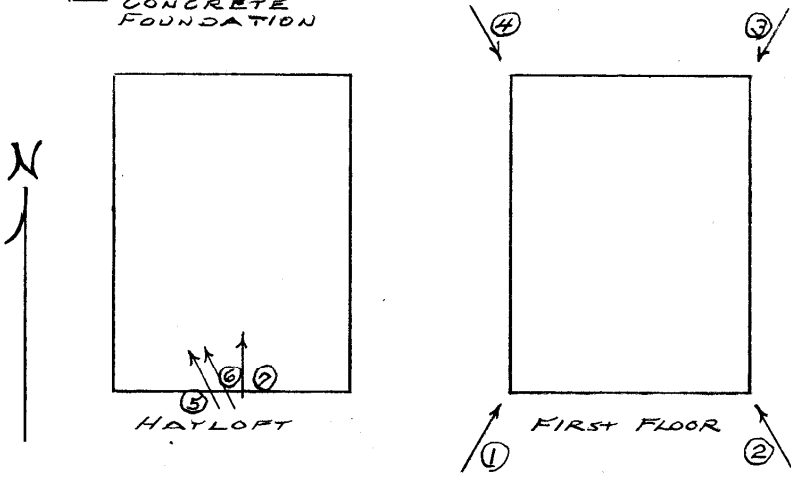

**SOUTH DAKOTA STATE HISTORIC PRESERVATION OFFICE
HISTORIC SITES SURVEY STRUCTURE FORM**



PHOTOGRAPHER: Jim Stone
DATE OF PHOTO: December 16, 2013

ROLL NUMBER: _____
PHOTO NUMBER: 1
CAMERA DIRECTION: Looking NE, SW corner



PHOTOGRAPHER: Jim Stone
DATE OF PHOTO: December 16, 2013

ROLL NUMBER: _____
PHOTO NUMBER: 2
CAMERA DIRECTION: Looking NW, SE corner

**SOUTH DAKOTA STATE HISTORIC PRESERVATION OFFICE
HISTORIC SITES SURVEY STRUCTURE FORM**



PHOTOGRAPHER: Jim Stone
DATE OF PHOTO: December 16, 2013

ROLL NUMBER: _____
PHOTO NUMBER: 3
CAMERA DIRECTION: Looking SW, NE corner



PHOTOGRAPHER: Jim Stone
DATE OF PHOTO: December 16, 2013

ROLL NUMBER: _____
PHOTO NUMBER: 4
CAMERA DIRECTION: Looking SE, NW corner

**SOUTH DAKOTA STATE HISTORIC PRESERVATION OFFICE
HISTORIC SITES SURVEY STRUCTURE FORM**



PHOTOGRAPHER: Jim Stone
DATE OF PHOTO: December 16, 2013

ROLL NUMBER: 5
PHOTO NUMBER: 5

**Hayloft, looking NW, 2x6
rafters with 2x6 bracing
from center of lower
rafter down to floor and
exterior wall, 4' O. C.**

CAMERA DIRECTION:



PHOTOGRAPHER: Jim Stone
DATE OF PHOTO: December 16, 2013

ROLL NUMBER: 6
PHOTO NUMBER: 6

**First floor, looking NW,
2x6 rafters with 2x6
bracing at roof hip, 2' O.
C.**

CAMERA DIRECTION:

**SOUTH DAKOTA STATE HISTORIC PRESERVATION OFFICE
HISTORIC SITES SURVEY STRUCTURE FORM**



PHOTOGRAPHER: Jim Stone
DATE OF PHOTO: December 16, 2013

ROLL NUMBER: _____
PHOTO NUMBER: 7

CAMERA DIRECTION: Hayloft, looking North,
2x6 rafters and North
gable end.

SOUTH DAKOTA STATE HISTORIC PRESERVATION OFFICE
HISTORIC SITES SURVEY STRUCTURE FORM



T-91-92-N FAIRVIEW DIRECTORY R-51-W

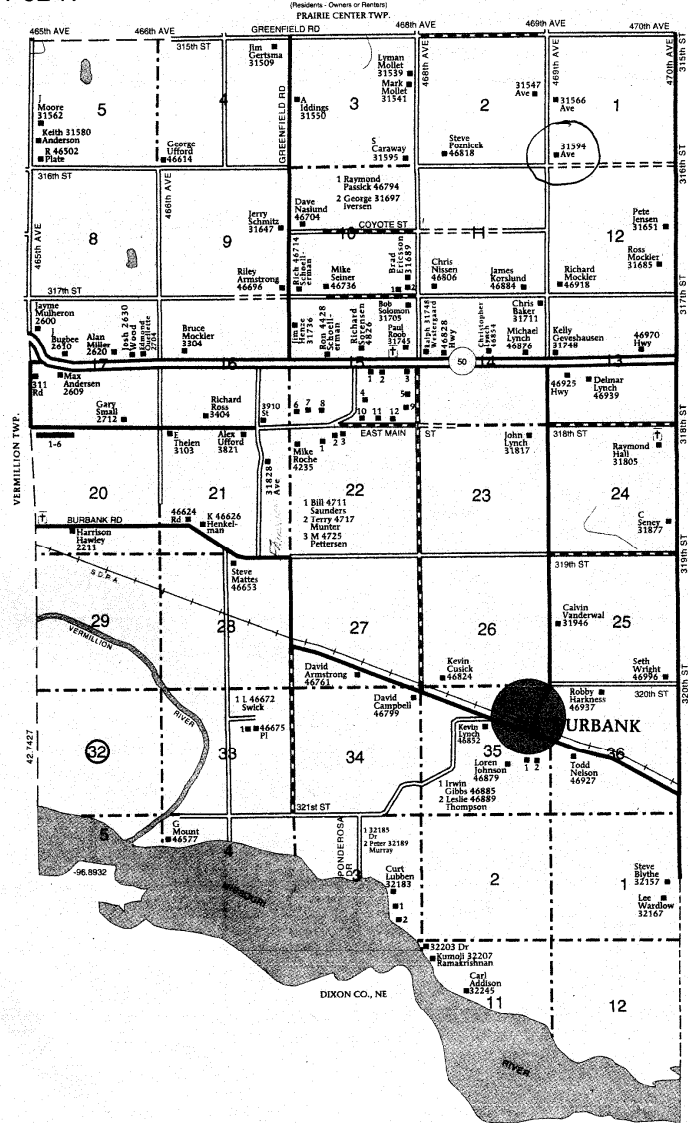

FAIRVIEW TOWNSHIP	6 Meyer, Leroy 4206	SECTION 20
SECTION 15	7 Nauertz, James 4306	1 2509
1 Turnbaugh, V 5009	8 Schoenrock, K 4424	2 Crew, M 2531
2 Aahes, Severn 5225	9 Knutson, Richard 5101	3 Neitzke, Mark 2703
3 Behrmann, David 31761	10 Mogck, John 4733	4 Cook, Cleland 2711
4 Albers, Dave 4745	11 Miller, Stan 4001	5 Missimino, Robin 2835
5 Ouellette, Loren 31785	12 Hovden, Donald 4905	6 Ahmed, Mike 2925

© Farm & Home Publishers, Ltd.

HISTORY

This farm located in the SW ¼ of Section 1, Fairview Township, Clay County was homesteaded by John Taylor.

The 1894, 1901 and 1912 Clay County Atlas lists Mary Taylor as the owner.

The 1924, 1937, 1948 and 1956 Clay County Atlas lists A. A. Solomon as the owner.

**SOUTH DAKOTA STATE HISTORIC PRESERVATION OFFICE
HISTORIC SITES SURVEY STRUCTURE FORM**

